

HONDA CBR650R / CB650R '19- REAR SETS for Honda quickshifter (original design)

part# H-65019RSQ

[R]-SIDE

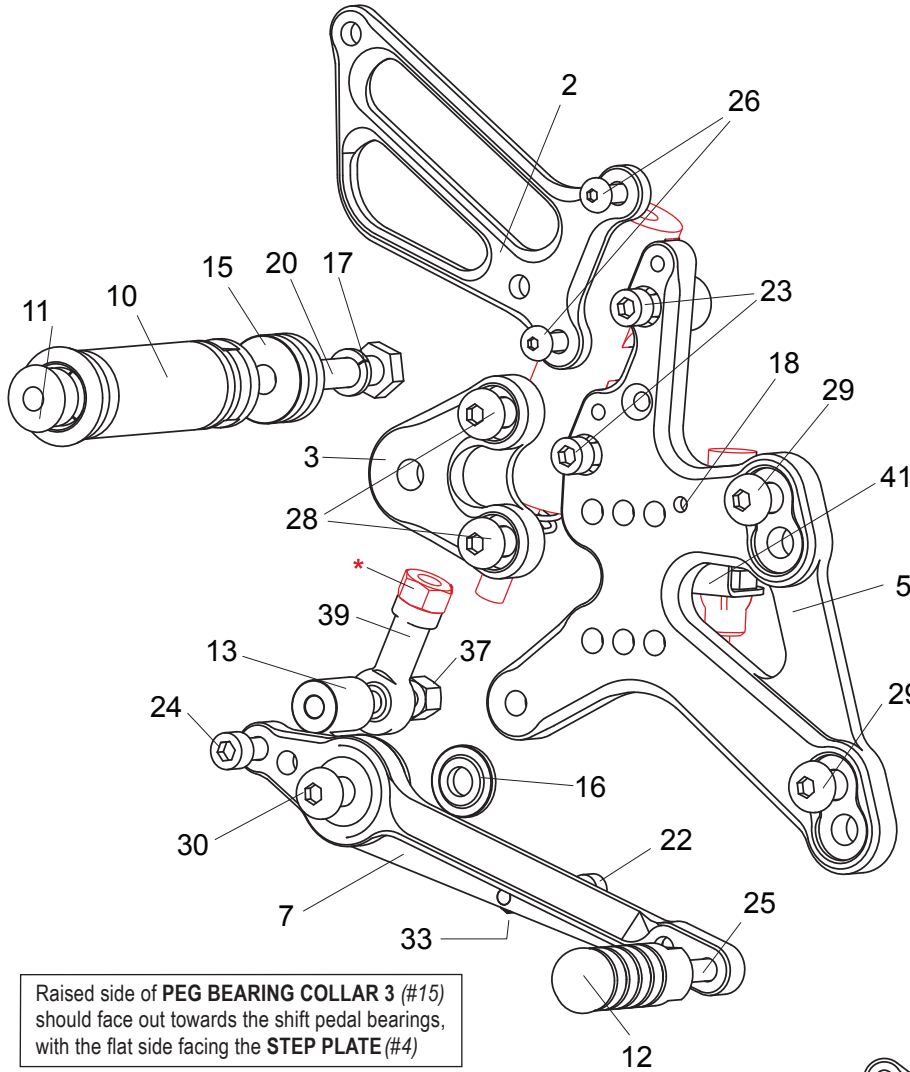

- 2. (R) HEEL GUARD [HG-1R]
- 3. (R) STEP PLATE [S-GSX105SP-L]
- 5. (R) BASE PLATE (BK) [H-650BP-R]
- 7. BRAKE PEDAL (BK) [BPD-19B]
- 10. FOOT PEG [PEG]
- 11. FOOT PEG END CAP [ST-002]
- 12. PEDAL TIP (DELRIN) [ST-001D18]
- 13. ROD END COLLAR 19 (BK) [RDED-CLR19]
- 15. PEG COLLAR 12 [PEGCLR-12]
- 16. PEG BEARING COLLAR 3 (BK) [PEGBGCLR-3SB]
- 17. SPLIT WASHER M8 [SWS-8]
- 18. HEX HEAD M5x8mm [HBT-M58]
- 20. HEX HEAD M8x40mm [HBT-M840]
- 22. SOCKET HEAD M5x40mm [SBT-M540]
- 23. SOCKET HEAD M6x15mm [SBT-M615] x 2
- 24. SOCKET HEAD M6x45mm [SBT-M845]
- 25. LOW SOCKET HEAD M6x20mm [LSBT-M620]
- 26. BUTTON HEAD M5x15mm [BBT-M515] x 2
- 28. BUTTON HEAD M8x15mm [BBT-M815] x 2
- 29. BUTTON HEAD M8x20mm [BBT-M820] x 2
- 30. BUTTON HEAD M8x30mm [BBT-M830]
- 33. NUT M5 [NUT-5]
- 37. LOCK NUT M6 [LNT-6]
- 39. FEMALE ROD END M6-8 [RDED-F6-8]
- 40. RETURN SPRING 20 [RS-RSP]
- 41. PULL SWITCH STAY 14 [PSTAY-14]

*** NUT (STOCK HONDA PART)**

Raised side of PEG BEARING COLLAR 3 (#15) should face out towards the shift pedal bearings, with the flat side facing the STEP PLATE (#4)

